

Stainless steel welding shank



Applications

This shank was specially designed by Trelleborg to weld on other type of end coupling, or stainless steel accessories such as valves, tes, elbows, ...

Technical description

This kind of swaged shank requires following of swaging procedures issued by Trelleborg.

Welding should preferably be carried out prior to swaging (when not possible, please make sure an efficient cooling is carried out during welding).

Article No.	ND shank mm	OD pipe x Thickness mm	Length mm	Stock item
Standard serrated shank stainless steel 316 L				
117196	25.0	25.0 x 2.0	45	•
5100274	32.0	33.7 x 3.25	49	•
117197	38.0	38.0 x 2.6	56	•
117198	51.0	51.0 x 2.6	66	•
117199	63.0	63.5 x 2.6	76	•
117200	76.0	76.1 x 2.9	78	•
117201	101.5	101.6 x 3.6	90	1
5100144	125.0	128.0 x 6.0	105	1
118269	150.0	158.0 x 8.5	128	1
Long serrated shank stainless steel 316 L (a)				
118034	25.0	25.0 x 2.0	90	•
5100275	32.0	33.7 x 3.25	95	•
118035	38.0	38.0 x 2.6	100	•
118036	51.0	51.0 x 2.6	110	•
118037	63.0	63.5 x 2.6	120	•
117976	76.0	76.1 x 2.9	120	•
117420	101.6	101.6 x 3.6	150	•
Ferrule				
Specific ferrules must be imperatively used to swage these couplings (see below " Swaging stainless steel Ferrules and Rings ")				

• = Stock item.
1 = Non stock.

(a) = Non stock, min. quantity = 10 pieces.

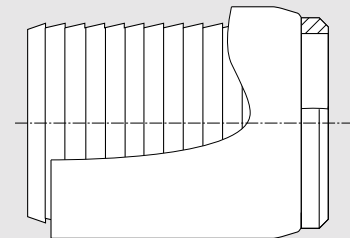

04 - 02 - 2002